

LIFTING POINT

- Place wheel chocks at both front and back of the wheels on the ground.

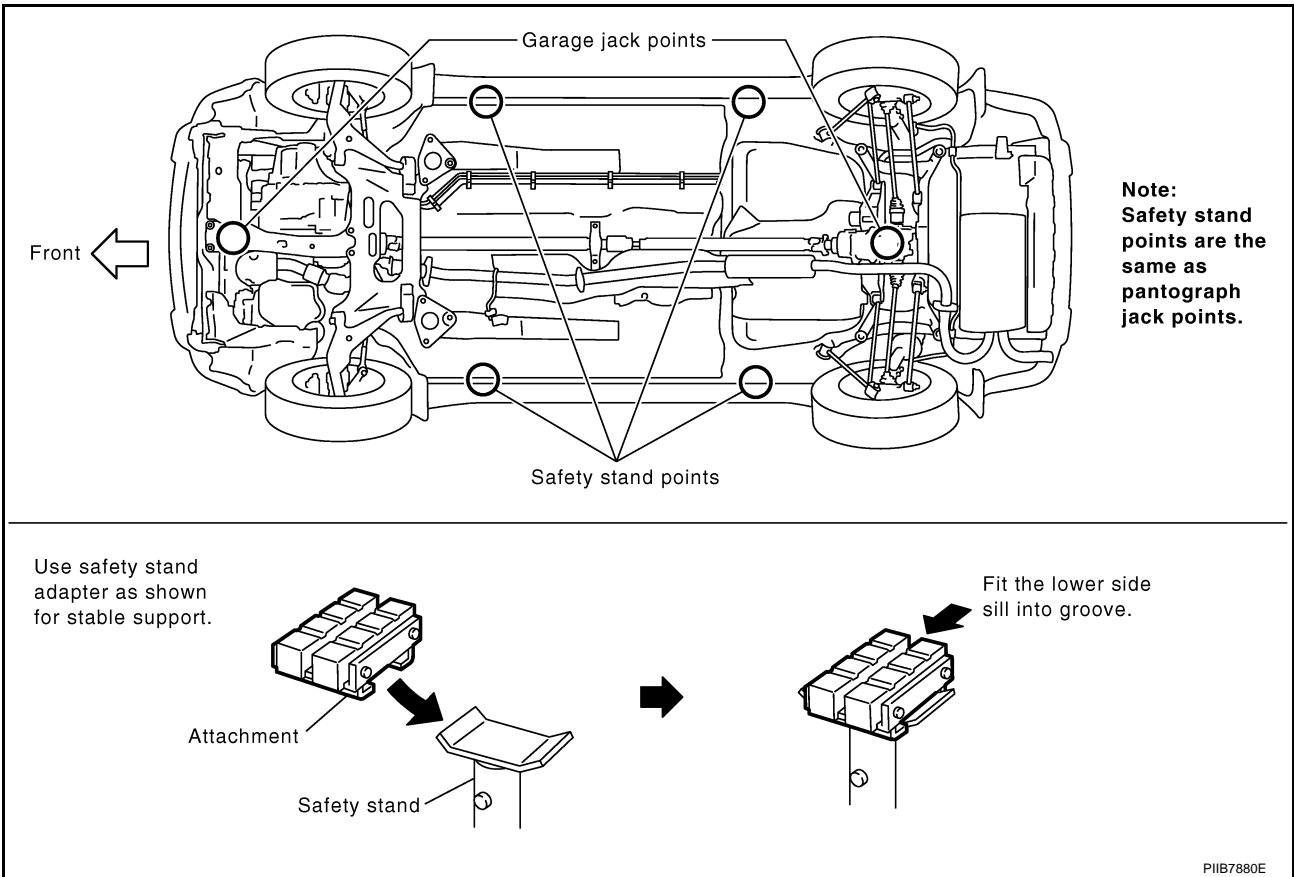

2-Pole Lift

BAS00023

WARNING:

When lifting the vehicle, open the lift arms as wide as possible and ensure that the front and rear of the vehicle are well balanced.

When setting the lift arm, do not allow the arm to contact the brake tubes, brake cable, fuel lines and sill spoiler.

